

Room to move and live

This home was designed to meet the owners' needs for practical living and a fun time. **Beth Muhling** reports.



This home in Victoria Park was custom-designed and makes great use of space.

Great use of space has been made in this two-storey home with four bedrooms in Sunbury Park Estate.

The home has two bathrooms, a home theatre, a study and a large open-plan living area.

Builder Gary Wright, of Right Homes, said the home had been custom-designed around the clients' lifestyle to offer a practical living space that was also well set up for entertaining.

One of the company's specialities was custom-built homes from about \$300,000, many of them small-lot homes with beautiful finishes.

With this house, there is 306sqm of space, with generous-sized rooms, on a 247sqm block.

At the front a stonework feature

two floors high adds an attractive final touch.

As you enter through the front door, the home cinema is on the left and the office, with built-in filing cabinets and cupboards, is on the right.

The office opens up at the front to a small, grassed courtyard — perfect for a coffee break.

Past the stairs are the open-plan kitchen, dining and family area.

A bulkhead ceiling defines the kitchen area, which features a wide island bench of Qstone in a Arctic white, with a breakfast bar on one side.

Other features in the kitchen are a D'Amanti stove and range hood and a built-in wine rack.

The living area opens up completely to the alfresco area via a row of stackable bi-fold doors across the side and another at right angles, creating an indoor-outdoor room.

The roof on the alfresco area, which has downlights, is slanted to let in more light.

At the back of the house, there's a double garage with storeroom incorporated, a laundry with drying courtyard and a powder room tiled to the ceiling.

The upper level houses the main suite, three minor bedrooms and the main bathroom.

At the top of the stairs, there's a large landing with a built-in display shelf for photographs and artworks.

Past that is the main suite, with a large walk-in robe and wall niches for display purposes, which opens to a Juliet balcony at the front of the home.

The big ensuite is open to the bedroom and has a separate toilet, double vanities and a stone worn wall on the shower to stop any splashing.

The second bedroom is double sized and also has a walk-in robe.

Down the wide hallway, there are two other good-sized bedrooms with built-in robes, another linen closet, a bathroom and a separate toilet.

Looking at Building a New Home?

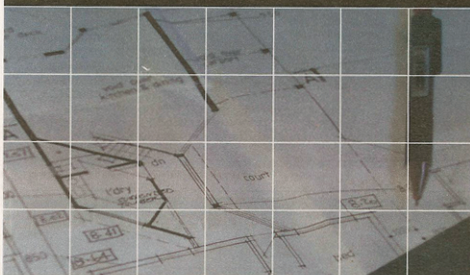

You need someone you can **trust**...

and is **honest, reliable** and up to date with industry knowledge.

Someone who belongs to a **professional** organisation.

Someone who **understands** your needs.

Build with the **best** in the business.



Ask if your Building Sales Consultant is accredited by the Housing Industry Association.

HIA Consumer Line 1902 973 555

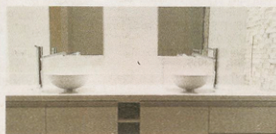

Custom Built Homes
\$400,001-\$500,000;
Small Lot Housing
\$350,001-\$450,000

Suburb: Victoria Park
Builder: Right Homes
Phone: 9355 0374

