

From start to finish, we take care of everything.

FREE SITE ASSESSMENT

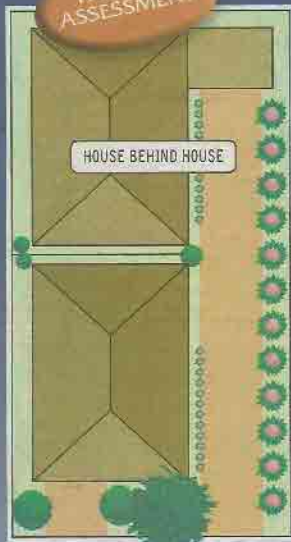

HOUSE BEHIND HOUSE

- 2-STOREY
- SINGLE STOREY
- Feasibility
- Plans
- Council Approval
- Demolition
- Construction
- Handover

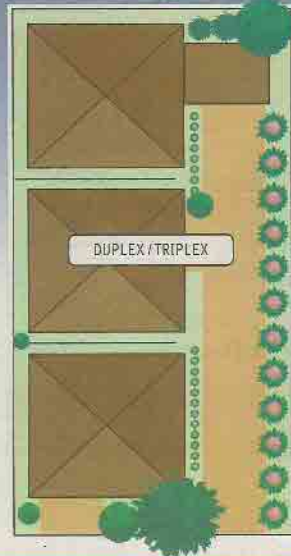

DUPLEX/TRIPLEX



MULTI-UNIT DEVELOPMENT

RELY ON OUR EXPERTISE

Groupex has the expertise and experience to develop your block in almost any way you can imagine. This includes multi-unit developments and triplexes as well as the conventional duplex and house behind house developments. Like to unlock the potential in your block? Call us today.



GROUPEX

FREECALL 1800 149 365 - Michael Cardiner
www.perceptions.com.au



The open-plan living area looks out to an alfresco area with a built-in barbecue.

Solar principles guided design

LISA CALAUTTI

Louvre windows are a focal point of the upper level of this Bassendean home.

Built by Right Homes, the windows were incorporated as part of good passive-solar design, consideration of neighbours and the fact the home faced north.

The owner said he wanted to build something that was reasonably solar efficient and a strip of frosted panels along the louvre windows prevented looking into neighbours' homes while ensuring the second storey's passageway and adjacent bedrooms were well lit.

Good passive-solar design is incorporated throughout the home with cavity wall insulation and a PV solar system.

Despite the block being little more than 9.5m wide, the home successfully fits four good-sized bedrooms, two bathrooms and a powder room.

The ground level features an open-plan living area with a galley-style kitchen and individual panel glass doors which open to a small alfresco area with a built-in barbecue.

A big walk-in pantry, stone benchtops, Bosch appliances and a Clipsal power strip are highlights of the kitchen.

The main suite, with an ensuite and large walk-in robe, is towards the back of the ground level. A powder room with wheelchair access is situated near the entrance.

A carpeted staircase with built-in lights, with storage space underneath, leads to the second level which has an office, minor bedrooms and a theatre room, which could also be used as a fourth bedroom.



This home was an entry in the 2010 HIA-NAB Perth Housing Awards.